

I-5 Improvements in North County

American Council of Engineering Companies

November 13th, 2019



Metro



Project Overview

- 13.6 miles of median widening for HOV lane, outside widening for Auxiliary Lanes and to accommodate standard typical section
- Widening undercrossings at 7 locations
- Removal and replacement of Weldon Canyon OC
- 44,760 LF of Retaining Walls
- 12,770 LF of Sound Walls. All sound walls along the freeway



Project Limits

- HOV Improvements from SR-14 to Parker Road
- ITS Improvements from I-405 to I-210



Overview of Improvements

from SR-14 to Butte Canyon

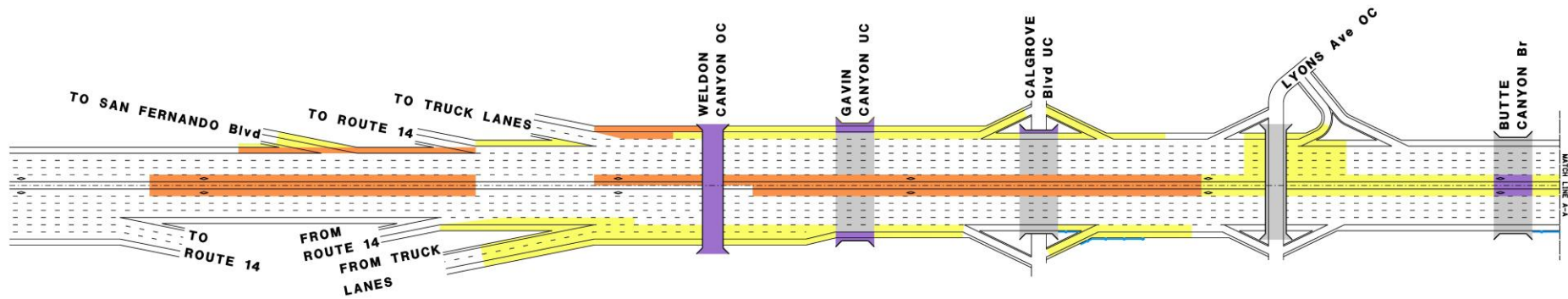
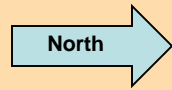

LEGEND:

- PREVIOUS PROJECT
- WIDENING
- BRIDGE WORK



Overview of Improvements

from McBean Pkwy to Rye Canyon Rd

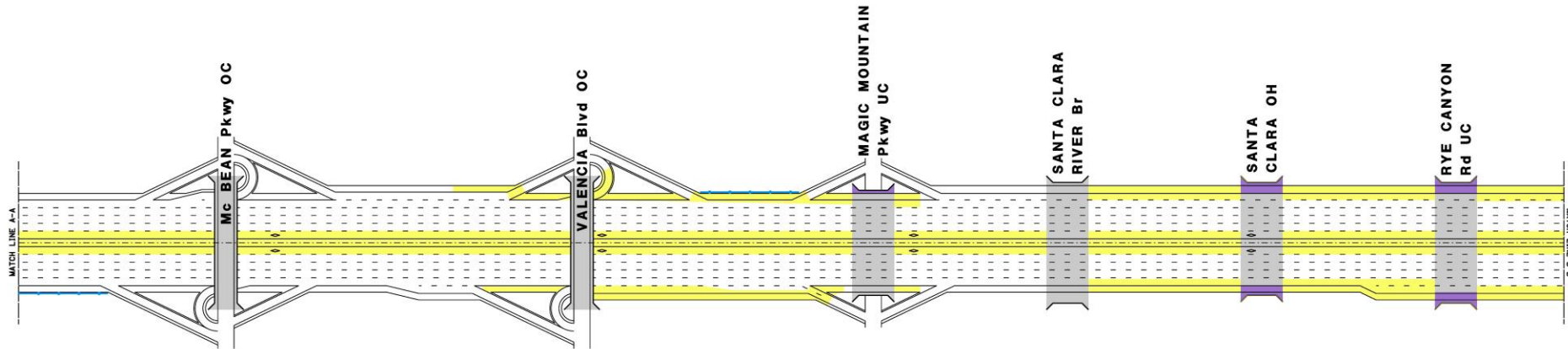
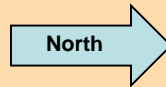

LEGEND:

- PREVIOUS PROJECT
- WIDENING
- BRIDGE WORK



Overview of Improvements from Rye Canyon Ramps to Parker Rd

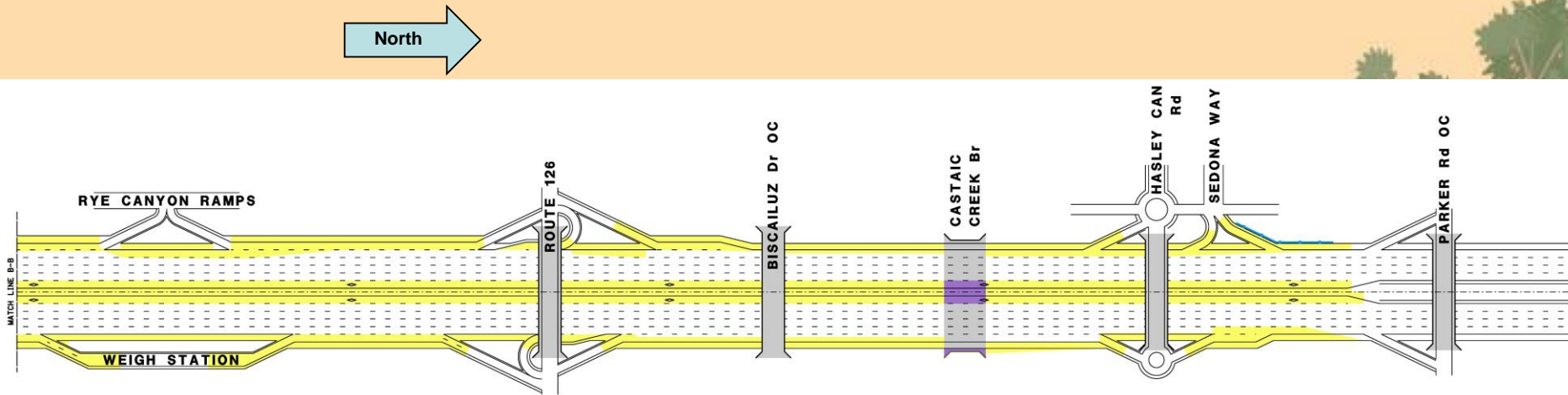

LEGEND:

- PREVIOUS PROJECT
- WIDENING
- BRIDGE WORK

Typical Section

Existing Narrow Median

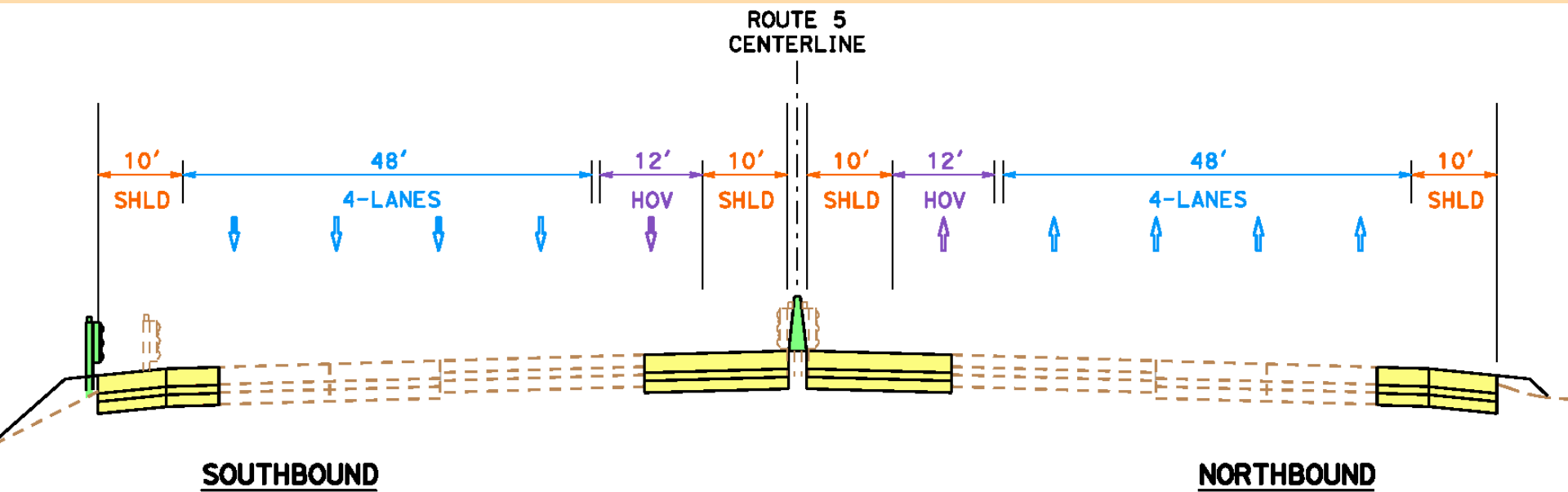

Typical Section

Existing Wide Median

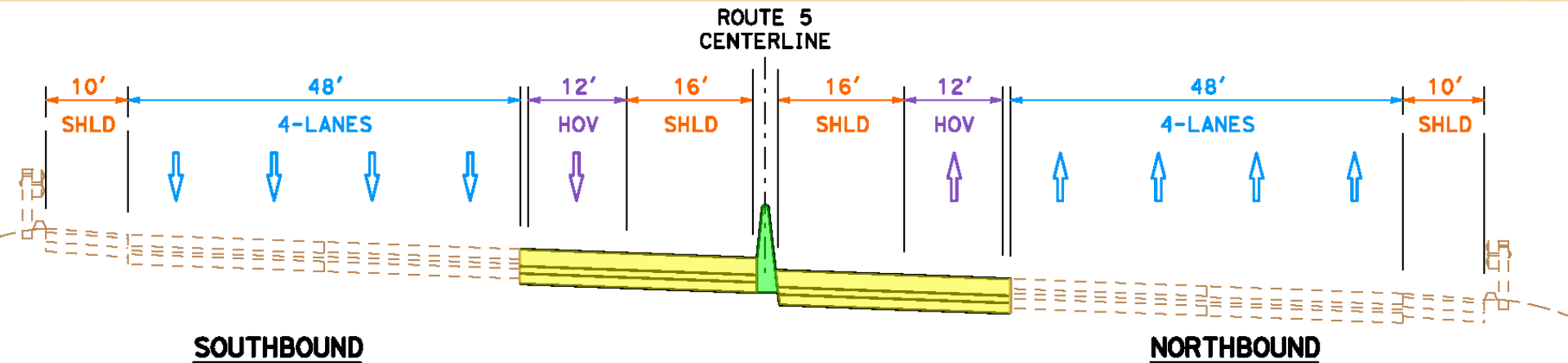

I-5 Lane Configuration

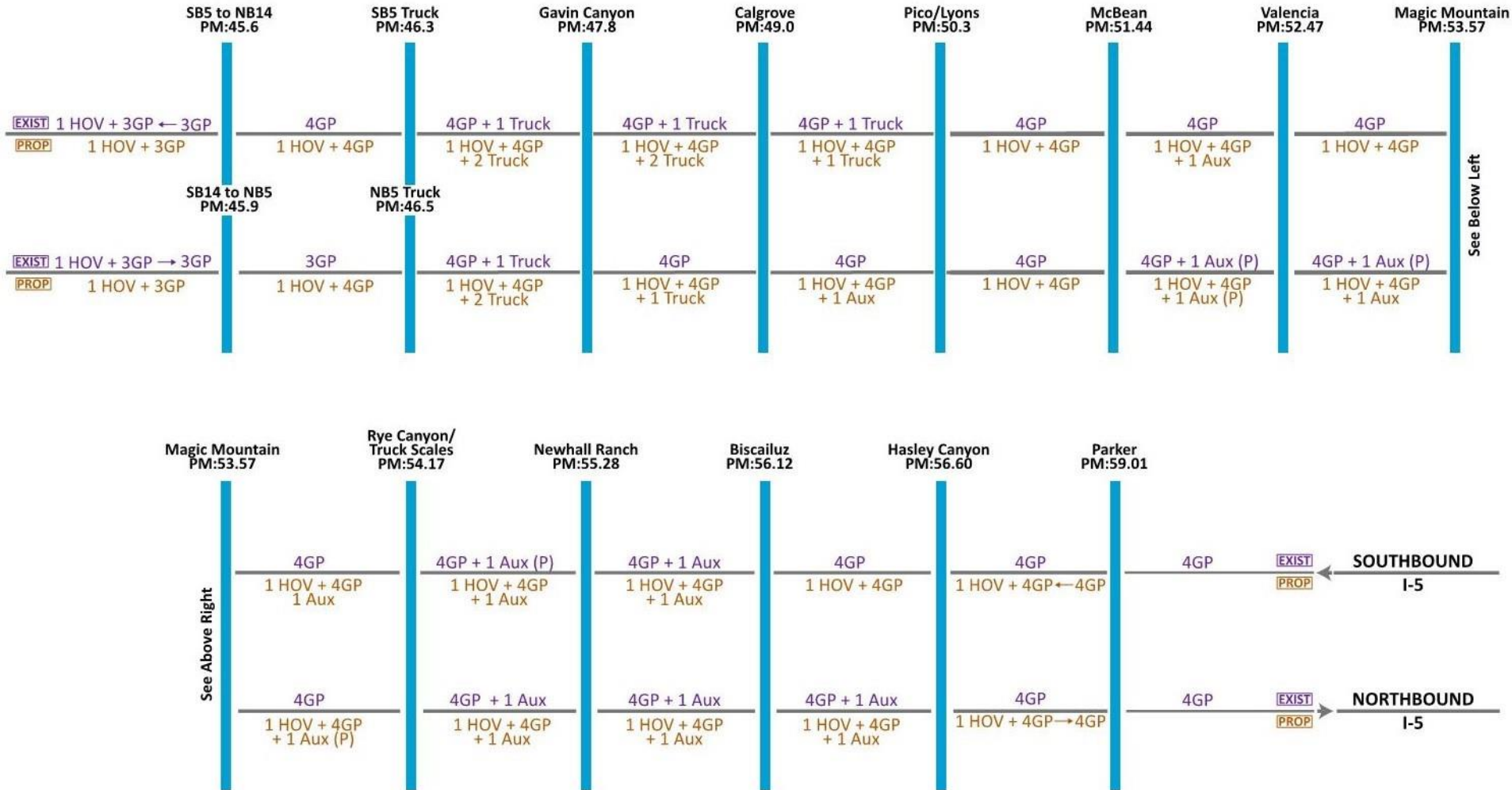

I-5 at Rye Canyon Rd (Existing)



I-5 at Rye Canyon Rd (Proposed)



I-5 at McBean Pkwy

Looking North (Existing)



I-5 at McBean Pkwy

Looking North (Proposed)



Existing Aesthetics

Barrier Aesthetics



Existing Aesthetics

Retaining Wall Aesthetics



Sound Walls

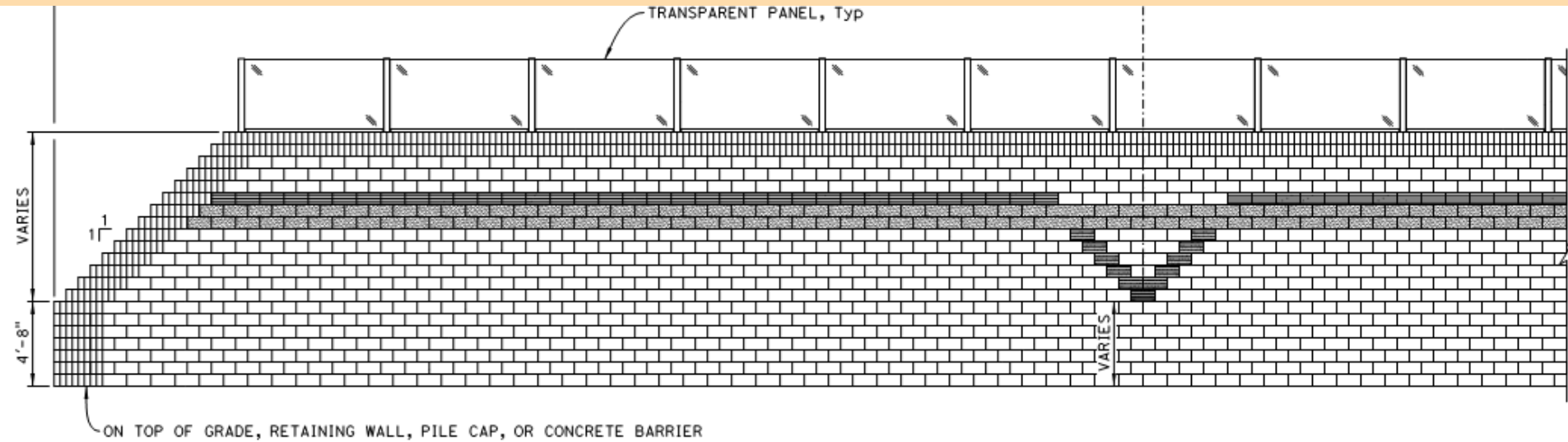

**PIF – Public Interest Finding for Transparent Panels.
Special Design for 2 Sound Walls 20' High, and 18' High – both with
4' high transparent panels**

Sound Walls



Sound Walls

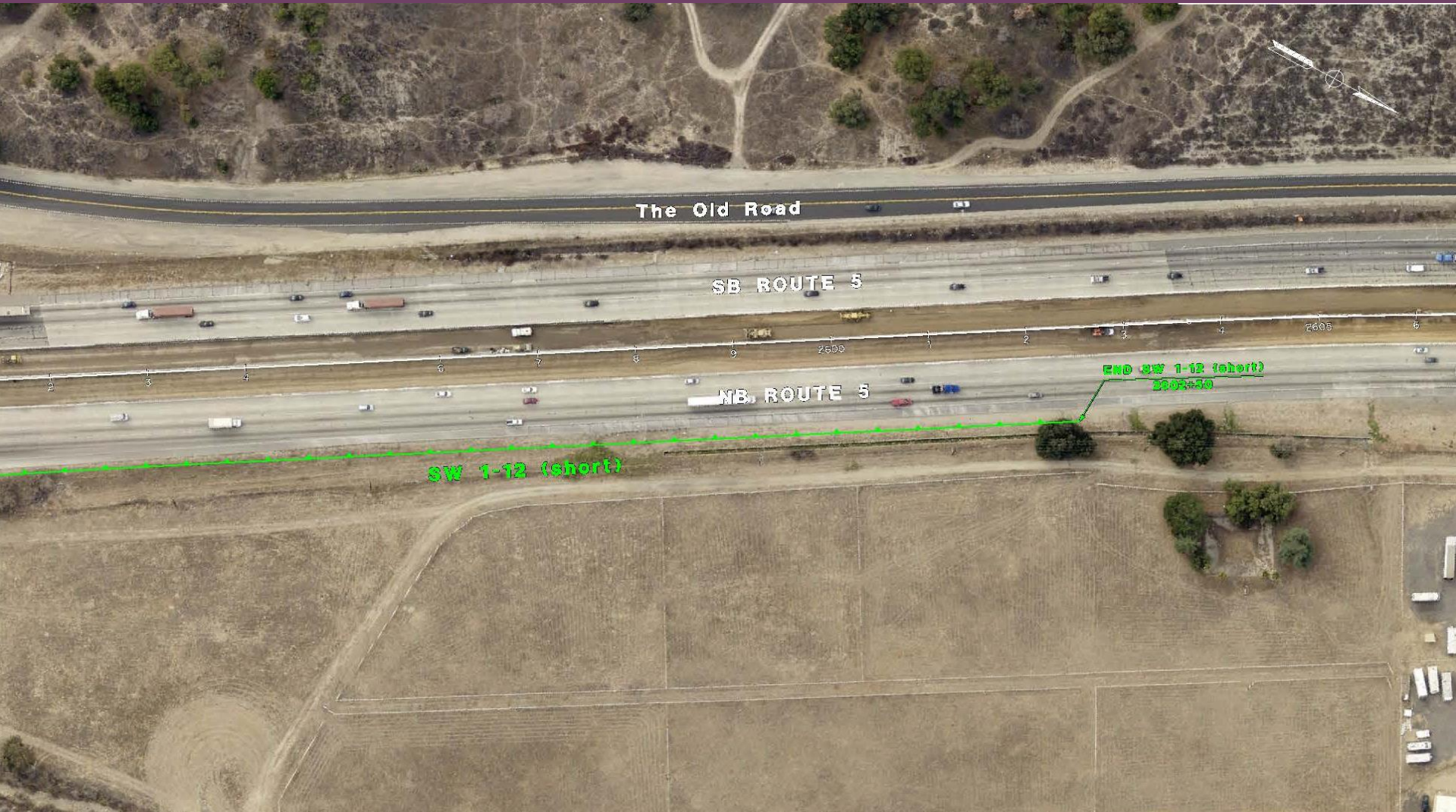

Sound Walls



Sound Walls



TPC VALENCIA GOLF COURSE

The Old Road

Beg SW 2-8 (short)
2772+00

SW 2-8 (short)

SB ROUTE 5

NB ROUTE 5

VALENCIA COUNTRY CLUB

ITS/ Ramp Metering/ Staging / ROW / Utilities/ Permits



ITS/ Hub Building

- Communication Hub Building at the I-5/I-405 Interchange
- Back Office Work at TMC
- Fiber Optics
- For I-405 to I-210 New Fiber in Existing Conduits
- Count Stations
- CCTV
- Extinguishable Message Signs
- Weigh in Motion Stations

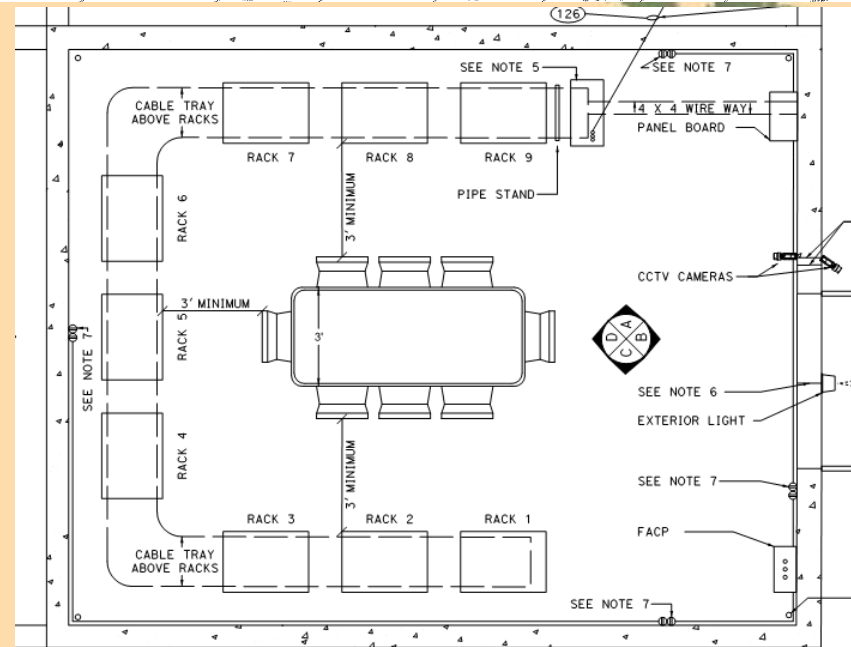
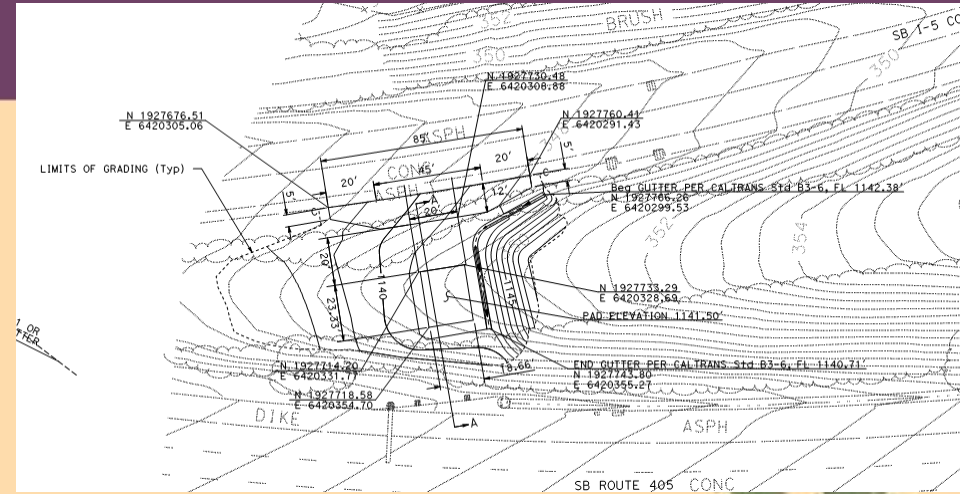

Freeway Closures

- Entire Freeway: Weldon Canyon Bridge Demolition and Falsework Erection/Removal
- SB Freeway for Lowering at Lyons Ave/Pico Canyon
- NB or SB Freeway for Existing OH Sign Bridge Structure Removal and New OH Sign Bridge Construction



ROW Needs

No.	CALTRANS CPN	APN	OWNERSHIP	TCE AREA (SQ. FT.)	PERM ESMT. AREA (SQ. FT.)	FEE ACQ AREA (SQ. FT.)	Type of Business/Use
1	80856-1	2861-071-009	Excel Buena Park, LP	2,940			Hotel under construction
2	80857-1	2866-009-011	Falstom Family Trust et al	576			Sunvair Inc./Landing Gear Overhaul
3	80858-1	2866-009-042	Jack C. Wilder Trust	1,608			Howard Custom Boat Dealer
4	80859-1	2866-013-098	RIF III-Avenue Stanford LLC	1,445			Howard Custom Boat Dealer
5	80860-1,2	2827-028-274	City of Santa Clarita	1,578		8	Property is vacant
8	80861-1,2,3	2826-025-905	Conservancy Authority	5,588	967	767	Property is vacant
9	80862-1	2826-005-028	Newhall Land	4,233			Vacant- owned by Newhall Land & Farming Company
10	80863-1	2826-005-029	Newhall Land	2,659			Vacant- owned by Newhall Land & Farming Company
11	80864-1	2826-005-030	Newhall Land	3,158			Vacant- owned by Newhall Land & Farming Company
12	80865-1	2826-005-801	Pacific Bell	2,432			Existing Industrial Building-owned by Pacific Bell
13	80866-1	2866-034-014	Newhall Land	12,564			Common Area Parcel-vacant- owned by Newhall Land & Farming Company
		2866-004-909					
14	81092-1,2	2866-004-911	County of Los Angeles	93,973	1,023		Vacant Land-Castaic Creek
		2866-004-912					
15	81095-1	2826-007-062 & 072	Newhall Land	35,550			vacant - owned by Newhall Land & Farming Company
	81093-1	2826-006-009	Newhall Land	21,321			Vacant- owned by Newhall Land & Farming Company
16	81094-1	2826-006-906 & 901	County Sanitation Dist. No. 4	9,493			Vacant- owned by County Sanitation District No. 4
17	81195-1	2861-071-007	G Three Properties LLC	318			Restaurant
18	81196-1	2861.071-008	Excel Buena Park LP	1,098			Hotel under construction

Utility Relocations

Owner	Disposition	Utility	Location	Sheet #
AT&T	Relocate	Buried Communications Conduits	Weldon Canyon Rd.	U-6
SCE	Relocate	Power Poles, OH wires, & Utility Vault	At Weldon Canyon Rd.	U-6
SCE	Relocate	Street Lights & Poles	The Old Road	U-12
AT&T	Relocate	OH Communications	South of I-5 and the Old Road	U-12
AT&T	Relocate	Buried Communication Cable	The Old Road	U-12
Verizon (wireless)	Relocate	OH Fiber Optic	The Old Road	U-12
Spectrum	Relocate	OH Fiber Optic	The Old Road	U-12
SCE	Relocate	Street Light Pole	The Old Road	U-12
SCG	Potential Relocation, pending Ut. Policy Exc. request	2" Gas	Crossing I-5	U-21
SCG	Relocate	16" HP Gas	Crossing I-5	U-23
SCE	Relocate	UG 16 kV Power	Rye Canyon	U-39
AT&T	Relocate	Buried Comm. Conduits	Rye Canyon	U-39
AT&T	Relocate	Buried Comm. Conduits	Crossing I-5 near Biscailuz	U-47
LA County	Relocate	12" Water	Crossing I-5 at Castaic Creek	U-48
CLWA	Extend Casing	24" Water in 42" Csg	Crossing I-5	U-50
SCG	Potential Abandonment, pending Ut. Policy Exc. Request	4" Gas	Crossing I-5	U-56



Metro

Environmental Permits

- United States Army Corps of Engineers Clean Water Act Section 404 Nationwide Permit 14
- Clean Water Act Section 401 Water Quality Certification.
- California Fish and Wildlife Code Section 1602 Lake or Streambed Alteration Notification
- Caltrans Statewide Stormwater Permit



Overview of Constructability Review Process

- Quantity Take-Offs – per Caltrans BEES Items
- Unit Costs reviewed vs. current bids
- Current Bidding Climate considerations
- Caltrans review, recommendations on unit costs
- Constructability Analysis
- Resource Driven Scheduling Analysis
- Implemented Quality Management Plan



Current Project Status

INDEX OF PLANS

SHEET No.	DESCRIPTION
1	TITLE AND LOCATION MAP
2-63	TYPICAL CROSS SECTIONS
64-67	KEY MAP AND LINE INDEX
68-126	LAYOUTS
127-245	PROFILES AND SUPERELEVATION DIAGRAMS
246-462	CONSTRUCTION DETAILS
463	WATER POLLUTION CONTROL QUANTITIES
464-521	CONTOUR GRADING PLANS
522-848	DRAINAGE PLANS, PROFILES, DETAILS AND QUANTITIES
849-907	UTILITY PLANS AND DETAILS
908	CONSTRUCTION AREA SIGNS
909-924	MOTORIST INFORMATION PLANS, DETAILS AND QUANTITIES
925-1275	STAGE CONSTRUCTION PLANS, DETAILS AND QUANTITIES
1276-1290	TRAFFIC HANDLING DETAILS
1291-1358	PAVEMENT DELINEATION PLANS, DETAILS AND QUANTITIES
1359-1514	SIGN PLANS, DETAILS AND QUANTITIES
1515-1544	SUMMARY OF QUANTITIES
1545-1725	RETAINING WALL PLANS AND DETAILS
1726-1756	SOUND WALL PLANS AND DETAILS
1757-1855	HIGHWAY PLANTING PLANS, DETAILS AND QUANTITIES
1856-2237	ELECTRICAL PLANS
STRUCTURE PLANS	
2238-2272	WELDON CANYON OC (REPLACE) Br No. 53-1796
2273-2348	GAVIN CANYON UC (WIDEN) Br No. 53-2790
2349-2371	CALGROVE Blvd UC (WIDEN) Br No. 53-1792
2372-2396	BUTTE CANYON Br (WIDEN) Br No. 53-2809
2397-2423	ROUTE 5/126 Sep (WIDEN) Br No. 53-2928
2424-2425	SANTA CLARA RIVER (BARRIER MODIFICATION) Br No. 53-29
2426-2453	SANTA CLARA OH (WIDEN) Br No. 53-0688
2454-2482	RYE CANYON Rd UC (WIDEN) Br No. 53-1688
2483-2512	CASTAIC CREEK (WIDEN) Br No. 53-0009
2513-2760	RETAINING WALL PLANS AND DETAILS
2761-2798	SOUND WALL PLANS AND DETAILS

- Roadway Plans – pending resolution of ADL
- Structures Plans – Approved
- Permits
- Right of Way
- Utility Cert. Approved
- Env. Reval, ECR
- Supplemental Project Report

Milestone Schedule

Concept Design Approval
Sept. 2016

35% Design
March 2017

65% Design
Dec. 2017

95% Design
June 2019

100% Design
November 2019

RTL
May 2020

Start of Construction
Fall 2020

Construction Duration
52 Months



Metro



Questions and Answers

